

## Parking Brake Lever, Remove and Install



### Remove

Parking brake trim from parking brake lever.

Parking brake cable from parking brake lever – clip and pin.

Parking brake lever from support bracket – two bolts, washers and spacers.



### Install

Parking brake lever to support bracket – two bolts, washers and spacers.

Parking brake cable to parking brake lever – pin and clip.

Parking brake trim to parking brake lever.

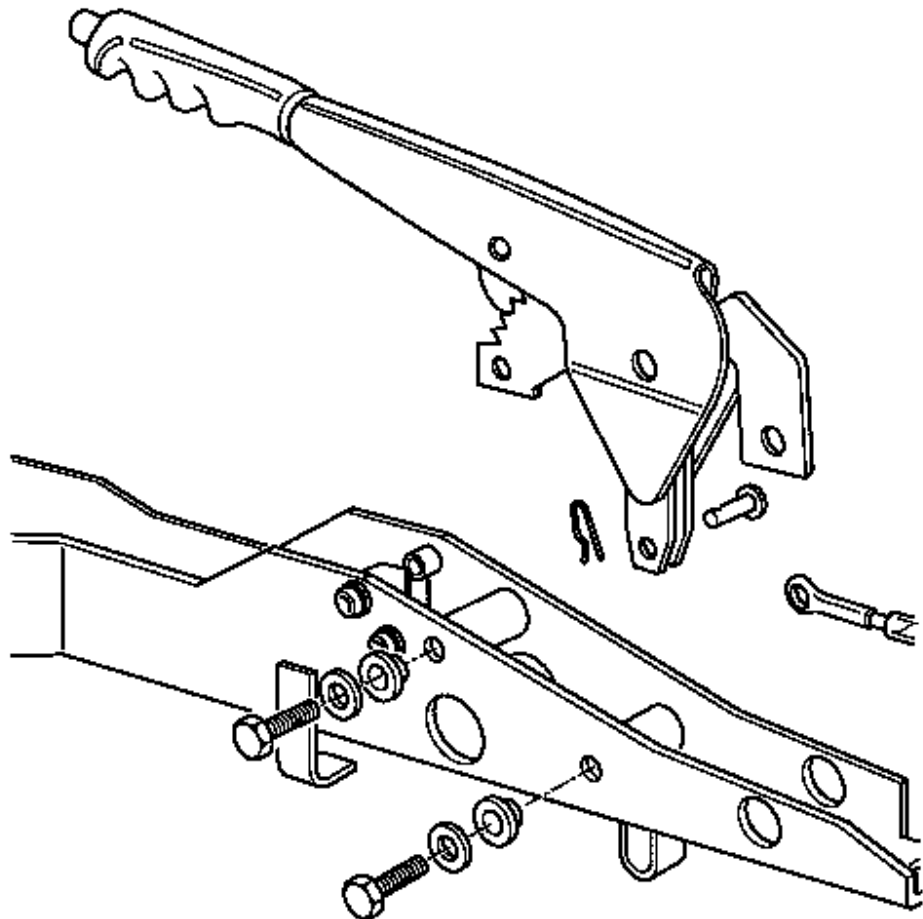

T 8777



### Adjust

Parking brake – see operation "Parking Brake, Check and Adjust".